



**Royal Association  
for Deaf people**



# Getting to our London office

**Address: Crystal Wharf, 36  
Graham Street, London, N1 8GJ**

**what3words: [///prop.grow.spend](https://www.what3words.com/prop.grow.spend)**



# Our office

**Address: 36 Graham Street,  
London, N1 8GJ**





# Public transport: Tube + Walk

## Angel Tube Station

Get off at Angel Tube Station (Northern Line)  
then a 10 minute walk

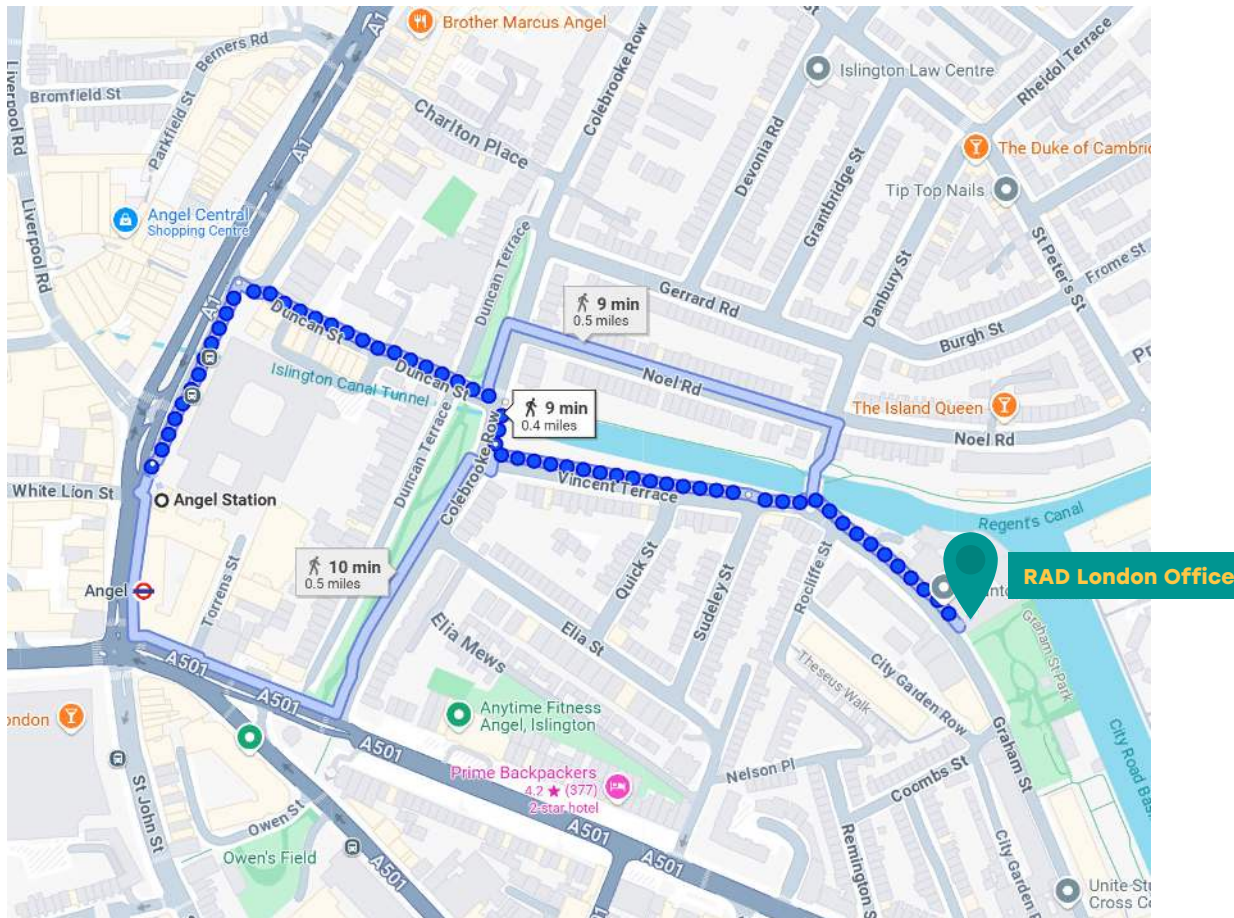

# Public transport: Train + Walk

## London Liverpool Street Station

30 minute walk, 15 minutes  
by car/taxi or 25 minutes with  
public transport

## Kings Cross Station

30 minute walk, 15 minutes  
by car/taxi or 20 minutes with  
public transport

## Euston Station

40 minute walk, 15 minutes  
by car/taxi or 20 minutes with  
public transport

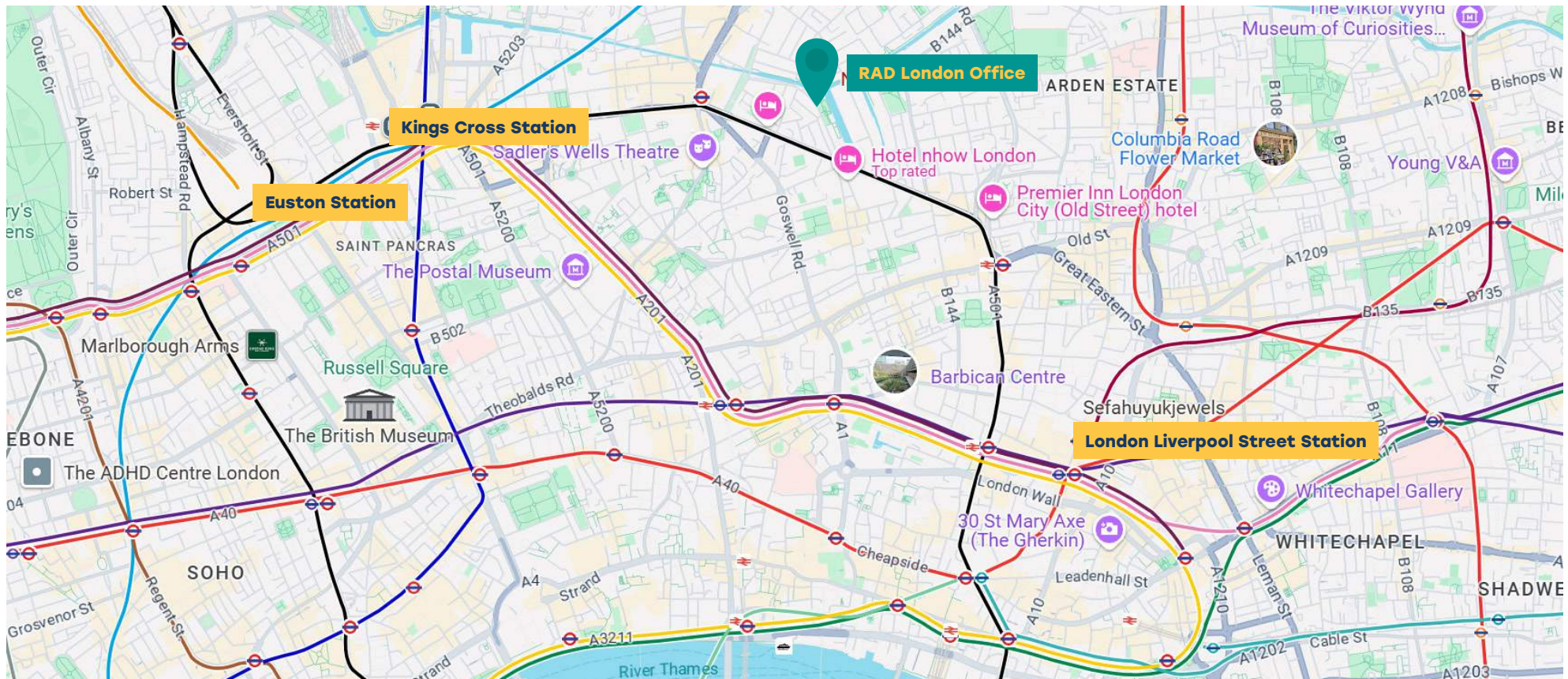



# Public transport: Bus + Walk

**205 from Liverpool Street**

**Arrive: Central Street (Stop UW)**

Then 5-10 minute walk

**205 from Kings Cross Station**

**Arrive: Central Street (Stop UV)**

Then 5-10 minute walk

**205 from Euston Station**

**Arrive: Central Street (Stop UV)**

Then 5-10 minute walk

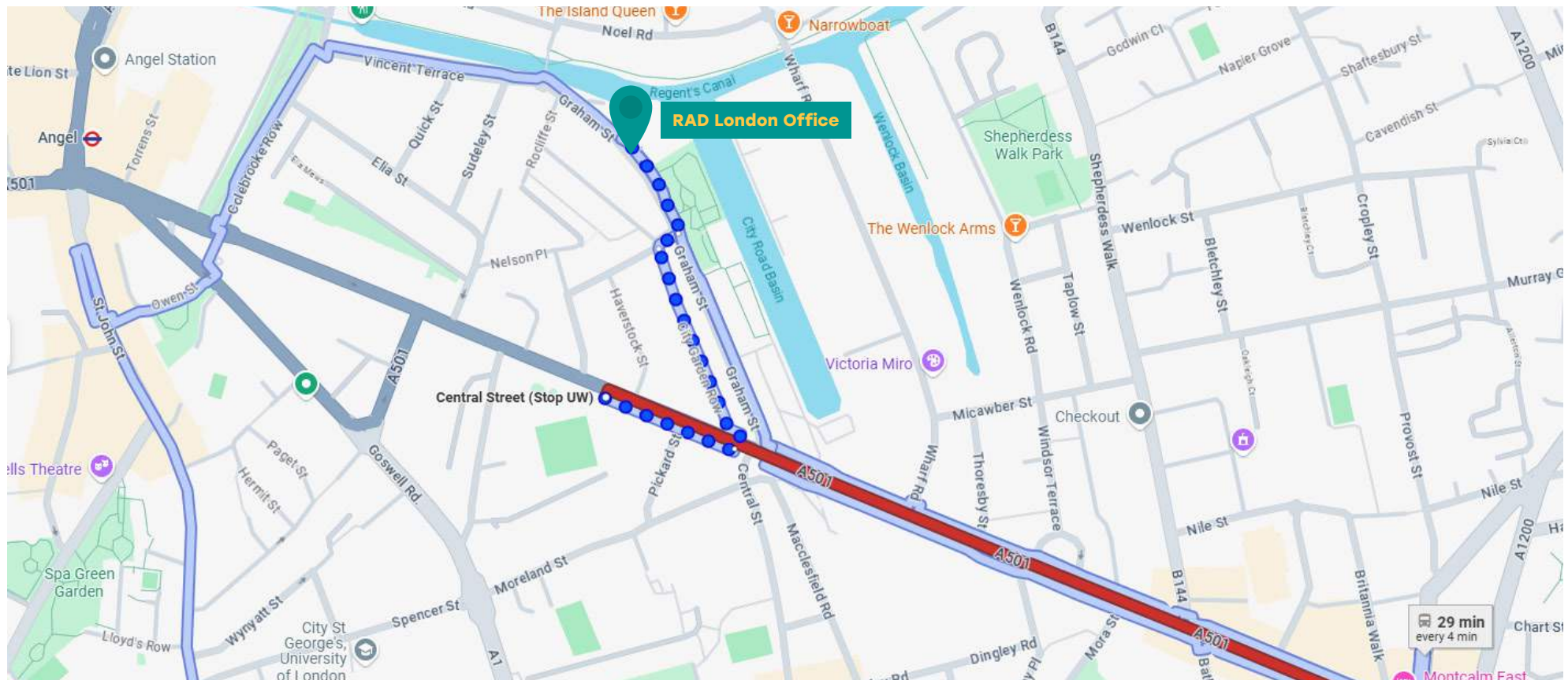

**royaldeaf.org.uk**

**info@royaldeaf.org.uk**

**0300 688 2525**

**Registered Charity No. 1081949 Company registered in England No. 3973353**  
**Patron: His Majesty King Charles III, founded 1841**